



What's your kitchen style?

Given how much time we spend in them – cooking, celebrating or just hanging out – today's kitchens must function for the way we live, but more importantly, they must feel personal.

So when it comes to defining your personal style, what says "home" to you? Do you lean more towards a modern aesthetic or does a traditional inspired setting soothe your soul? No matter where you are on the style spectrum – with Kitchen Craft – you're sure to find a look that's a reflection of you and your home.





Scandinavian Inspired

The simple life.



door style: Gentry

species: MDF

finish: Stillwater

door style: Gentry

species: Maple

finish: Frappe

► **FOR MORE FINISH OPTIONS:**

Visit kitchencraft.com/products



This stunning kitchen celebrates the core principals of Scandinavian design with a clean-line, minimalistic setting that seeks to combine functionality with beauty.

To balance the bright white walls, a nature inspired colour palette was selected for the cabinetry featuring a soft watery blue and a warm light toned maple island.

Additional texture was threaded through the kitchen by lining maple Frappe within the wall open shelf area and behind the glass doors.



01



04



05



07



09

ORGANIZE



02



03



06



08



10

No more hide and seek

Imagine finding what you want when you need it! Kitchen Craft's interior storage solutions are designed to provide efficiency as well as comfort of use. All of our storage accessories glide out with ease to reveal your cabinet's contents, making accessibility a breeze!

FOR MORE STORAGE SOLUTIONS:

Visit kitchencraft.com/interiors



In addition to our wood crafted storage solutions, we also offer a clean sleek line called Affinity. All Affinity storage solutions are constructed with a dark grey metal frame. This dynamic collection pairs nicely with many contemporary door styles. Affinity - storage with style.

01 Two Drawer Base
Our deep drawer storage can accommodate up to 45" in width.

02 96" Tall Dispensa Pantry Pull-out
This pantry fully extends allowing you to access from either side. Take stock of your pantry at a glance without buying a duplicate item again!

03 Corner Wall Twister
Rotating shelves turn 360° in this 40" High Cabinet.

04 96" Tall Pantry Pull-out
Maximize your pantry's storage with both door mounted and roll-out shelving.

05 Cleaning Caddy
Removable side tray lifts out easily, making your cleaning supplies portable.

06 Base Pull-out Create dedicated prep storage for your knives and utensils. Shelves and storage components are adjustable to suit your organizational needs.

07 Double Waste Bin Pull-out
Two bins helps you manage waste and recycling all in one zone.

08 Lemans Blind Corner Shelves
Perfect for storing large pots and serving dishes, these shelves extend and rotate completely out of your corner cabinet for easy access.

09 Spice Rack
Shelves are adjustable to fit taller spice jars.

10 Corner Easy Reach
Rotating shelves turn 360°. Fence guards and nonslip shelf surface keeps contents in place.



door style: Elan
species: Maple
finish: Winter, Alabaster, and Weathered Slate

door style: Aluminum Frame, Profile 3
finish: Brushed Stainless
glass insert: Clear Glass



GIVE YOUR MODERN KITCHEN AN EDGE!
 These sleek aluminum glass doors are available in a variety of profile and insert options. Visit our website for full product offering.



01

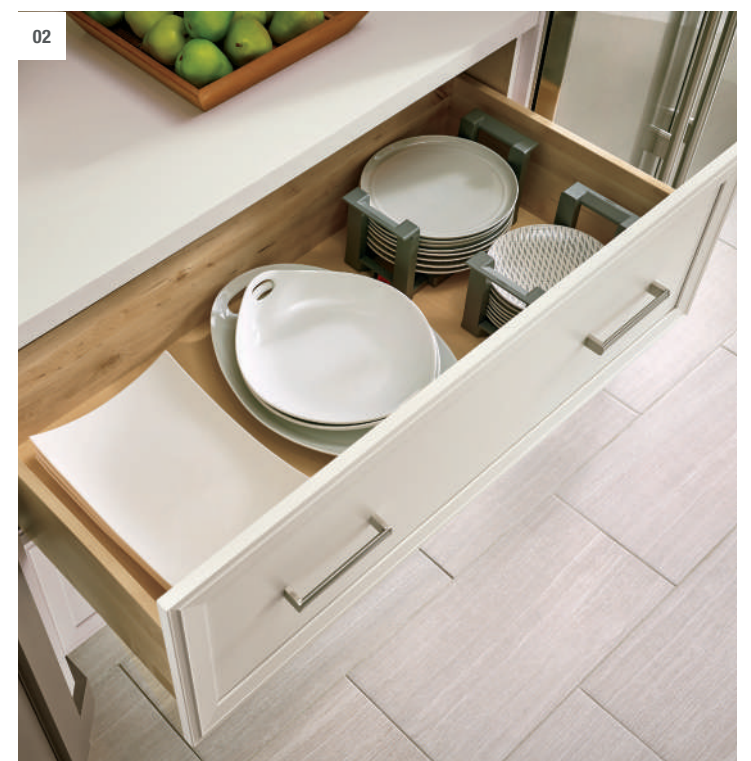

02

Modern farmhouse

The best memories are often made over a meal. Make your island equally unforgettable with a statement piece like this. The artisan brush strokes of the Weathered Slate finish give this island a sense of history, like it's always been there, yet the aluminum glass doors add a modern edge.

01 A Little Bit Country. The beefy posts and open shelving at the end of the island give the appearance of a farm table.

02 Think Differently. Deep drawers are an optional location to house your plates. Drawer plate organizers keep plates in place and allow you to easily carry the stack right over to the table.



There's always room for one more.

If you have a big family or piles of friends who love to drop by, consider incorporating banquette seating into your kitchen. The benefit of opting for bench seating is that there's room for everyone to congregate around the table.

door style: Elan
species: Maple
finish: Winter and Alabaster

► **FOR MORE FINISH OPTIONS:**
Visit kitchencraft.com/products



KITCHEN

style tip

Look at how this built-in banquette seating creates a cozy yet chic dining area that's as perfect for after-school homework as it is for a 6-person dinner party. And the best part? It's practical too.

Clever efficiency



Kitchen Craft cabinets have the design flexibility to create beautiful, functional kitchens at any size. This u-shaped kitchen features several deep drawers that provide an abundant amount of storage. To maximize every square inch of space, shallow cabinets have been placed at the end of each cabinet run that face the adjacent living room. This provides additional storage as well as a soft transition between living spaces.

door style: Asher

species: Maple

finish: Cirrus

door style: Aluminum Frame, Profile 3

finish: Natural Aluminum

glass insert: Frost Glass

► FOR MORE FINISH OPTIONS:

Visit kitchencraft.com/products



01



02

DESIGN TIPS

Make a compact space smart and stylish

1 Keep It Light. If you have a short window like this and space is premium, wall cabinets can be placed above. Frosted glass doors create the illusion that the window extends upward. Lighting inside the cabinets also creates a nice glow at night.

2 Take A Seat. Extending the countertop on your peninsula is a great way to create an eat-in bar area. It's the perfect spot for meals on-the-go or for the kids to do their homework.

EASY LIKE
Sunday morning

door style: Salem
species: Maple
finish: Alabaster



01



02

Casual comfort

From the soft taupe paint to the beach planked floor and white cabinets, this shaker kitchen is bathed in a warm, monochromatic colour palette. This was a purposeful design choice as the goal of this renovation was to create a space that is open and welcoming for big family get-togethers.

01 Double Duty. This island is all business in the front with the dishwasher conveniently placed next to the sink. To save counter space, the microwave has been built into the island as well. The overhang on the back comfortably seats guests for entertaining.

02 Kitchen Party. This little nook makes an excellent beverage centre. The tall wall cabinets feature glass doors that allow the homeowner to display their beautiful serving dishes and stemware.



A character study

In this kitchen, the homeowners desired a modern take on the rustic farmhouse style. The pairing of the Pearson shaker door style with the Weathered Slate finish brought this look together. The hand brushed technique used to create this finish is in keeping with the grey trend of today, yet the rich character from the brush strokes offers a comfortable heritage feel, adding to that country flavour.

The modern rustic feel is further complemented with the sleek look of the open shelving and this stunning wood hood. Its presence grounds the room while exuding charm.

door style: Pearson
species: Maple
finish: Weathered Slate





Refined elegance

Featured in Soho Ore, this striking vanity is a modern take on mid century design with its black streamlined woodgrain texture. Installing the wall hung vanity within this niche creates a floating, airy affect.

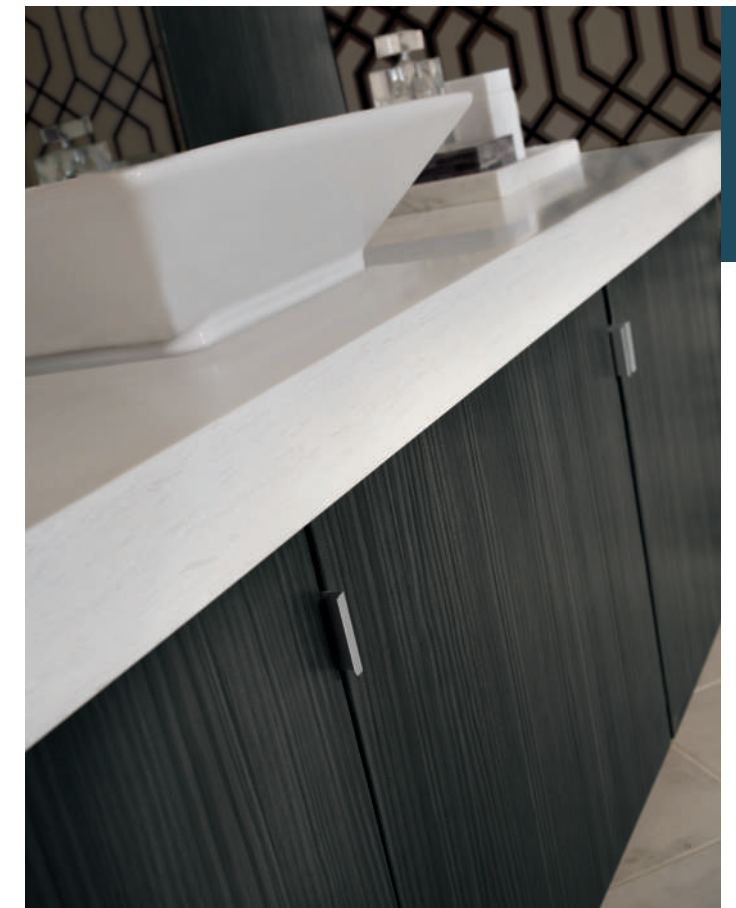

style tip

The retro vibe of this bath is elevated with this vintage graphic wallpaper and sparkling chrome accents. The high contrasting white solid surface and vessel bowl sink sets off this brilliant vanity.

door style: Soho
species: Thermofoil
finish: Woodgrain Textured Ore

► **FOR MORE FINISH OPTIONS:**

Visit [kitchencraft.com/products](https://www.kitchencraft.com/products)

Built with Confidence

When it's your forever home, the physical structure and rigidity of your cabinets should be first and foremost. That's why Kitchen Craft provides durability you can count on.

We stand behind the craftsmanship of each cabinet with a Lifetime Warranty.

Rest assured, your investment is protected for as long as you own your home.



ALL PLYWOOD UPGRADE

** All plywood components meet ANSI/HPVA HP-1 standards, and may contain MDF or particleboard.*

specifications

		STANDARD	ALL PLYWOOD UPGRADE*
WALL DEPTH	12 5/8" exterior depth	•	•
	11 3/4" interior depth	•	•
SIDES	5/8" furniture board sides	•	
	5/8" plywood* sides		•
TOP & BOTTOM	5/8" furniture board top and bottom	•	
	5/8" plywood* top and bottom		•
BACK	3/16" hardboard back with 5/8" thick mounting strips	•	
	3/16" plywood* back with 5/8" thick mounting strips		•
SHELVES	5/8" adjustable furniture board shelves	•	
	5/8" adjustable plywood* shelves		•
INTERIOR	White or Natural melamine cabinet interior	•	
	Natural plywood* cabinet interior		•
HINGE**	Fully concealed, six-way adjustable Smart Stop™ soft-closing hinge	•	•
	170° hinge	Upgrade	Upgrade
DRAWER**	Hardwood dovetail drawer with undermount, full extension SmartStop™ guides	•	•
	Metal drawer with undermount, full extension SmartStop™ guides	Optional	Optional



Deep Wall Cabinets.

The standard interior depth of our wall cabinets is 11 3/4". This gives you the storage flexibility you need for your oversized plates and serving dishes.

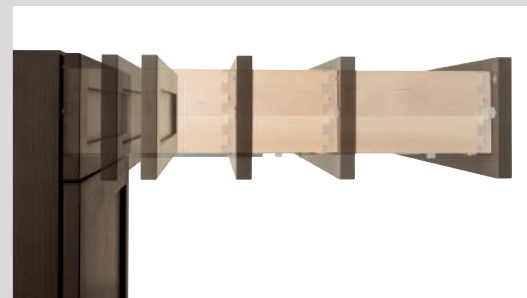

Wood Dovetail Drawer Box Is Standard

All Kitchen Craft cabinets feature full extension dovetail drawer boxes with under-mount SmartStop™ guides. You're guaranteed a gentle close every time!



Metal Drawer Box Option

Our Metal Drawer Box option offers the same features of the dovetail drawer but, with sleek double wall metal sides. It's the perfect choice for a clean, contemporary kitchen.



Melamine Drawer Box Option

Our Melamine Drawer Box option offers the same features as the dovetail drawer box with the choice of a white or natural finish to match your cabinet interior.

Let's Nest

Our homes have become our sanctuary, where we escape the pressures of everyday life. So it only makes sense that the centre of your home, your kitchen, evokes that feeling of comfort every day.

Find your comfort by choosing a door style and perfect complementary finishes for your kitchen.

This legend guide shows which materials each door style and finish are available in.

- Ⓜ Maple
- Ⓢ Cherry
- Ⓞ Oak
- Ⓡ Rift Oak
- Ⓐ Rustic Alder
- Ⓑ Bamboo
- Ⓣ MDF
- Ⓣ Thermofoil
- Ⓟ PureStyle™
- ⓔ Melamine
- Ⓨ Acrylic



CHOOSE WHAT YOU LOVE

To help you through the selection process, explore our online Door Visualizer Tool. Here, you will be able to select the exact cabinet door profile, species and colour combination. Use your favourites to collect all of your top picks!



DOOR VISUALIZER
kitchencraft.com/products

DOOR STYLES



Aher
 ⓂⓈⓄⓇⒶ



Beckett
 Ⓣ



Berkeley
 ⓂⓈⓄⓇⒶ



Bradford
 ⓂⓈⓄⓇⒶ



Bristol
 Ⓣ



Chelsea
 ⓂⓈⓄⓇⒶ



Cochrane
 Ⓣ

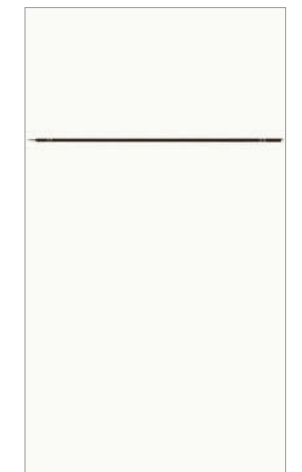

Contempra
 ⓔ



Contempra Horizontal
 ⓔ



Coventry
 Ⓣ



Delaney
 ⓂⓈⓄⓇⒶ



Elan
 ⓂⓈⓄⓇⒶ

DOOR STYLES



Gentry
M C O R A D

Glendale
T

Henley
P

Keelie
M C O R A D



Kenna
M C O R A D

Lexington
M C O R A

Lockhart
M C O A

Matlon
P



Marquis
M C O R A

Newhaven
M C O R A D

Paloma
M C O R A

Pearson
M C O R A

DOOR STYLES



Plymouth
M C O B A

Preston
T

Salem
M C O R A D

Sheffield
M C O R A



Soho
T

Soho Horizontal
T

Summit
M C O R D Y

Summit Horizontal
R B



Tamarind
M C O R A

Templeton
M C O R A

Whittington
M C O R A

Winfield
M C O R A

PAINTS



PRETTY IN PINK

Any paint colour you desire for your cabinetry is possible - even the hottest pink!

Available on Maple and MDF door styles, Kitchen Craft offers the ultimate in flexibility with our Custom Colour Program. Find a colour that inspires you, choose a paint chip from any paint manufacturer that represents that colour, and we will match it!

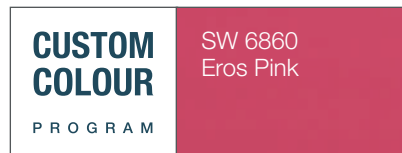

CUSTOM COLOUR
kitchencraft.com/get-started/design-your-room/custom-color

PAINTS WITH GLAZES

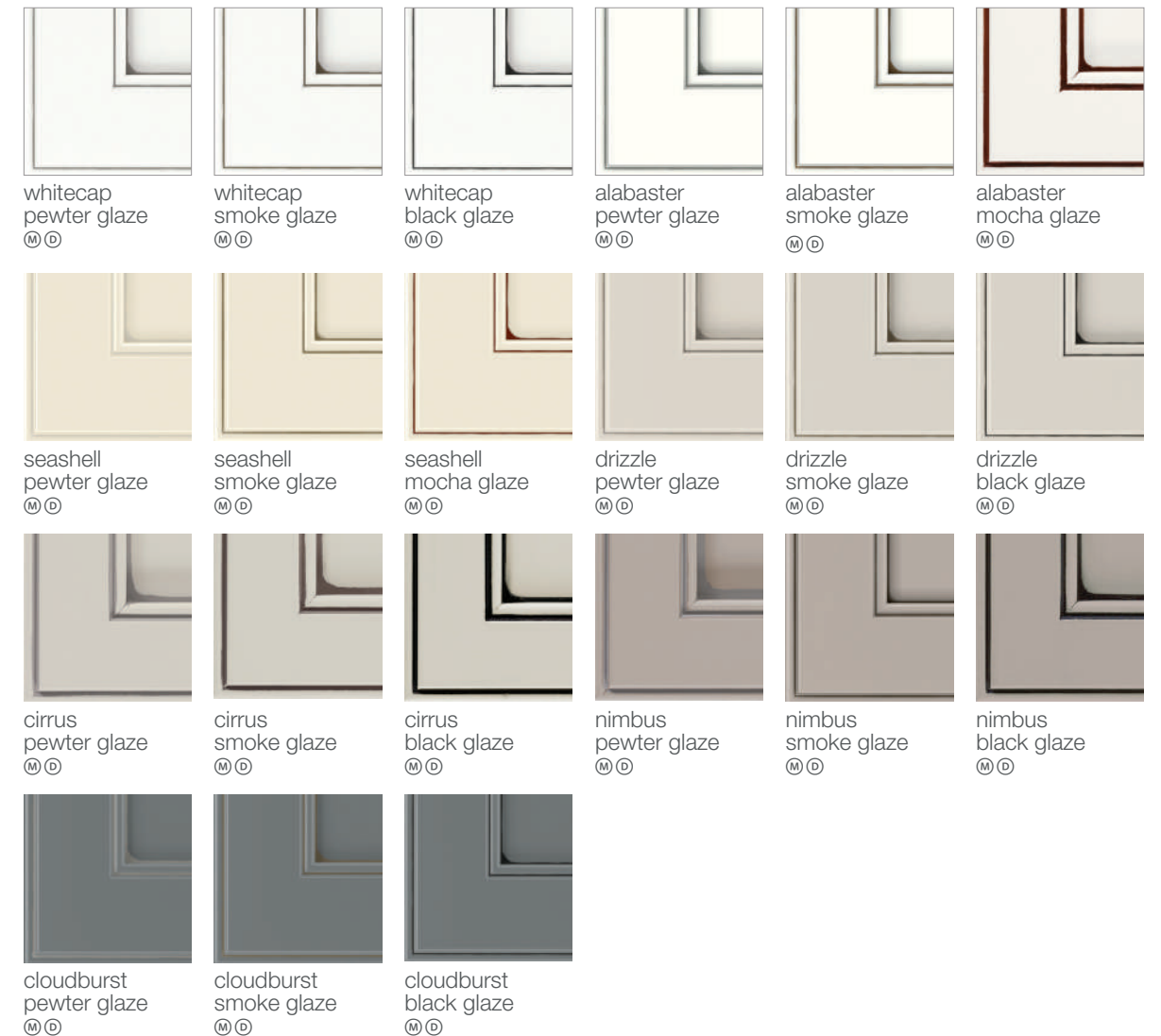

HAND BRUSHED FINISHES

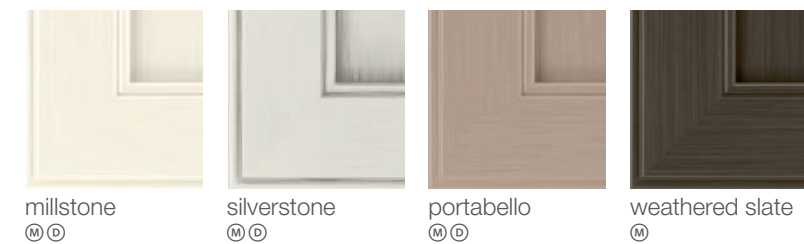

① Not available on Lockhart and Summit

When a painted finish is specified, the center panel may be constructed of Medium Density Fiberboard (MDF). MDF provides a smoother finish when painted, and is more resistant to warping, expansion, and contraction.

WOOD STAINS



natural (M)(O)(R)(A)(B)
ginger (M)(C)(R)(A)
spice (O)(R)
tuscan (M)(C)(O)(R)(A)(B)
toffee (M)(C)(R)(A)
sienna (M)(C)(O)(R)(A)



winter (M)(C)(O)(R)(A)(B)
frappe (M)(C)(O)(R)(A)(B)
cortado (M)(C)(O)(R)(A)(B)
thunder (M)(C)(O)(R)(A)(B)
cappuccino (M)(C)(O)(R)(A)
espresso (M)(C)(O)(R)(A)



charcoal (M)(C)(O)(R)(A)(B)
gunmetal blue (M)

WOOD STAINS WITH GLAZES



natural mocha glaze (M)(A)
ginger mocha glaze (M)(C)(A)
ginger black glaze (M)(C)(A)
frappe mocha glaze (M)(C)(A)
frappe black glaze (M)(C)(A)
winter pewter glaze (M)(C)(A)



winter black glaze (M)(C)(A)
tuscan mocha glaze (M)(C)(A)
tuscan black glaze (M)(C)(A)
cortado mocha glaze (M)(C)(A)
cortado black glaze (M)(C)(A)
toffee mocha glaze (M)(C)(A)



toffee black glaze (M)(C)(A)
sienna mocha glaze (M)(C)(A)
sienna black glaze (M)(C)(A)
thunder pewter glaze (M)(C)(A)
thunder black glaze (M)(C)(A)
cappuccino black glaze (M)(C)(A)



espresso black glaze (M)(C)(A)
gunmetal blue black glaze (M)

COLOUR THEORY

Wondering what it would look like to have a light stain on your wall cabinets and a blue paint on your base cabinets? Our online Kitchen Visualizer Tool allows you to mix door styles and colours to find your personal look.

Complete your mood board by selecting the countertop, backsplash, flooring and appliance colour that will pair nicely with your cabinetry.

- (M) Maple
- (C) Cherry
- (O) Oak
- (R) Rift Oak
- (A) Rustic Alder
- (B) Bamboo
- (D) MDF
- (T) Thermofoil
- (P) PureStyle™
- (E) Melamine
- (Y) Acrylic

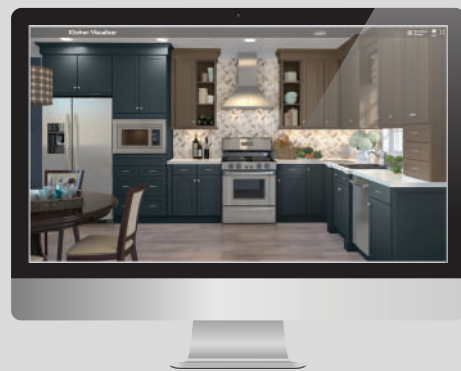

KITCHEN VISUALIZER
kitchencraft.com/kitchenvisualizer

HAND BRUSHED FINISHES



weathered slate (O)(R)(T)

COLOURS



WOODGRAINS

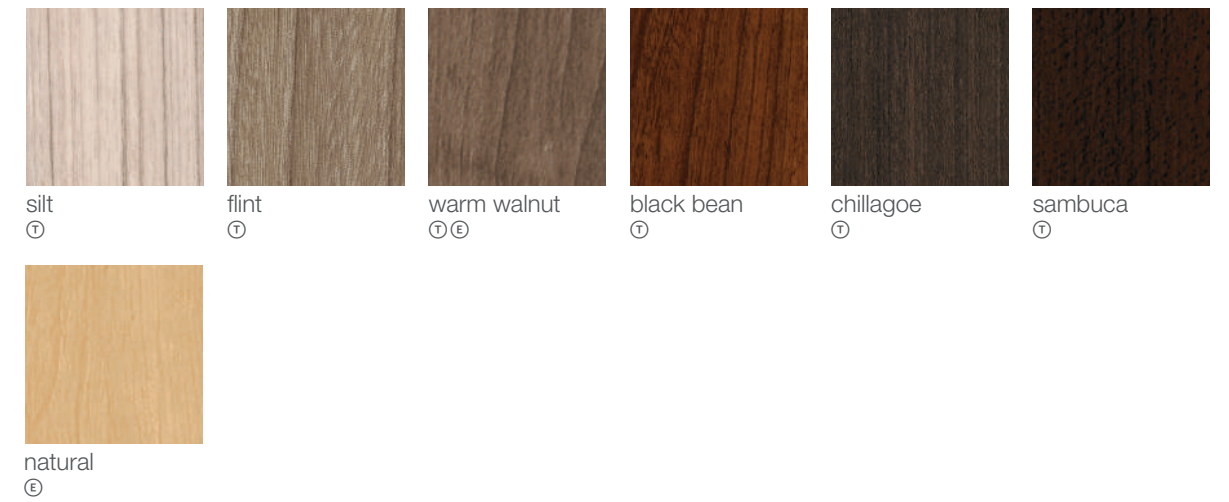

TEXTURED WOODGRAINS



- (M) Maple
- (C) Cherry
- (O) Oak
- (R) Rift Oak
- (A) Rustic Alder
- (B) Bamboo
- (D) MDF
- (T) Thermofoil
- (P) PureStyle™
- (E) Melamine
- (Y) Acrylic



Styles, product availability and construction may vary slightly from those shown in this catalog due to material availability and/or design evolution. Specifications are subject to change without notice. For more details, see www.kitchencraft.com or contact your designer.

Product photography and illustrations have been reproduced as accurately as printing technologies permit. To ensure highest satisfaction, we strongly recommend you view an actual sample for best colour, wood grain and finish representation.



kitchencraft.com
 #KitchenCraftCabinetry
 ©2022 MasterBrand Cabinets, Inc.

2022-05/BTL/8.8M
 MSKCFULL0619